



Installation Guide

Model Y Sill Protectors



Tesloid INC

contact@tesloid.com

contact@tesloid.ca

 Read the instructions in this installation guide carefully before attempting the install.

Copyright © 2024 Tesloid INC. All rights reserved.

Installation Guide
Model Y Sill Protectors

1. Recommended Tool(s) to Aid Installation

 Hair Dryer

 Cleaning Cloth

2. Preparation Before Installation



Before you begin the install, please prep the surface for a strong hold. Clean the surface of application thoroughly with a damp cleaning cloth (i.e. microfiber) and ensure no dust or dirt is present on the surface. Then, use the 'Adhesion Promoter' included with your product. This preps the surface for a strong hold and ensures it stays in place for years to come.

3. Begin the Install

There are 4 pieces in the package.



- A** Driver Sill Protector
- B** Passenger Sill Protector
- C** Rear Left Sill Protector
- D** Rear Right Sill Protector

4. Driver and Passenger Sill Protectors



Velcro Reinforcement



Alignment Point

Push the velcro reinforcement as depicted by the red arrow in the Left photo above. Use the seat risers as an alignment point as depicted in the photo to the right above.



Once the piece is perfectly aligned. Start by peeling off the double sided tape. The rubber seal of the Model Y should slightly overlap with this piece. Then, start to apply pressure over this piece so it glues on top of the surface. Apply firm pressure multiple times.

Installation Guide
Model Y Sill Protectors

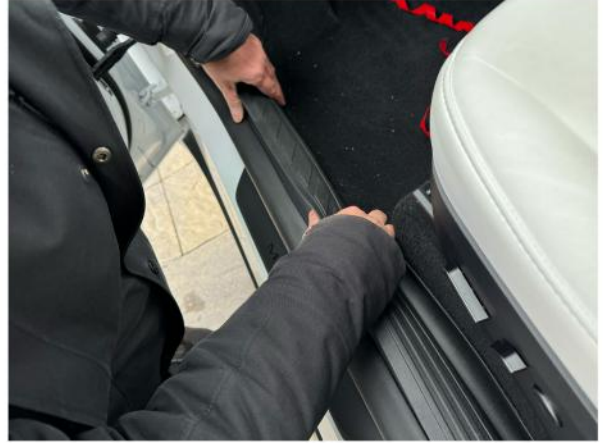

Now, begin to tuck the excess overlapping material of your Model Y Sill protector underneath the rubber seal of the Model Y. The factory rubber seal should completely cover the excess material of the Sill Protectors from start to finish. This will ensure the protectors stay in place for years to come. Failure to follow this step may result in sill protectors losing adhesive over time and start to fall off.

Once satisfied, repeat the exact same process for the passenger Sill Protector as well.

Optional Recommended Step



We recommend using a hair dryer to reinforce adhesive of the double sided tape. Run the hair dryer on low heat for 30-60 seconds from top of the sill protectors where the tape makes contact. Reinforce the material again by applying firm pressure on the sill protectors.

Installation Guide
Model Y Sill Protectors

5. Rear Right and Rear Left Sill Protectors

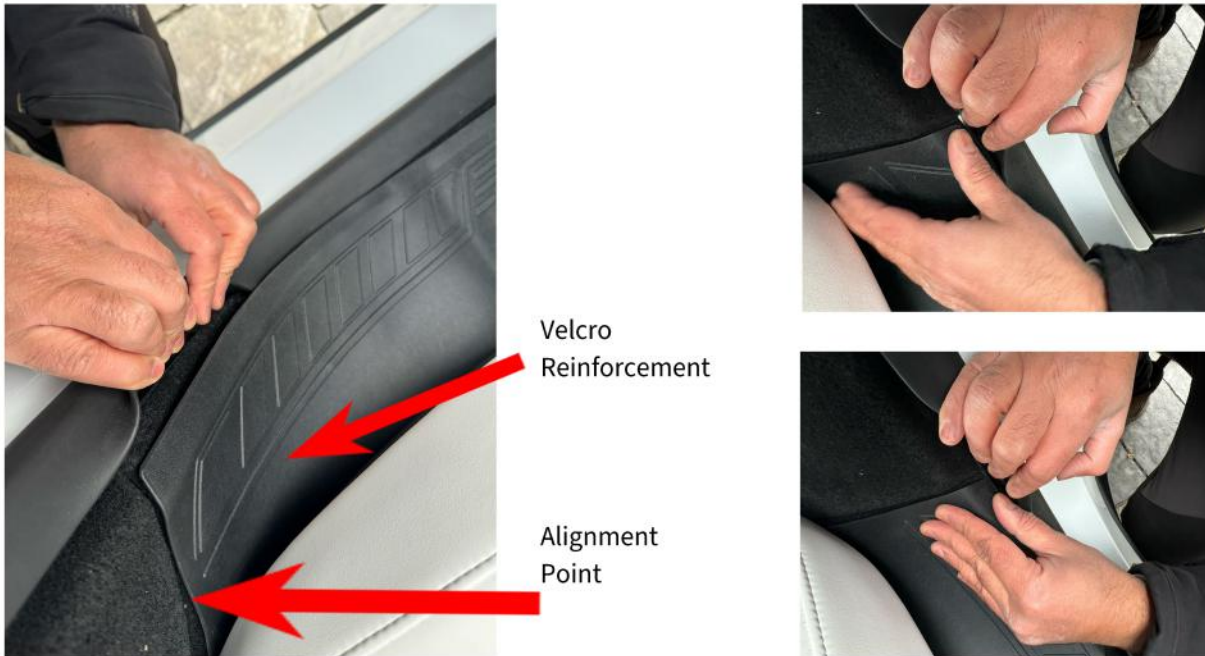

Start by aligning the sill protector to the line as depicted above. Then, push the velcro reinforcement as depicted by the top arrow in the photo above.



Once the piece is perfectly aligned. Start by peeling off the double sided tape. The rubber seal of the Model Y should slightly overlap with this piece. Then, start to apply pressure over this piece so it glues on top of the surface. Apply firm pressure multiple times.

Installation Guide
Model Y Sill Protectors



Now, begin to tuck the excess overlapping material of your Model Y Sill protector underneath the rubber seal of the Model Y. The factory rubber seal should completely cover the excess material of the Sill Protectors from start to finish. This will ensure the protectors stay in place for years to come. Failure to follow this step may result in sill protectors losing adhesive over time and start to fall off.

Once satisfied, repeat the exact same process for the Rear Right Sill Protector as well.

Optional Recommended Step



We recommend using a hair dryer to reinforce adhesive of the double sided tape. Run the hair dryer on low heat for 30-60 seconds from top of the sill protectors where the tape makes contact. Reinforce the material again by applying firm pressure on the sill protectors.